



Application

A high pressure pipe is used when an oil injector cannot be connected directly to a pressure joint or when a adaptor block is needed to connect the pressure gauge.

Description

High pressure pipes consist of a hollow steel pipe with a steel ball fitted in each end. Two swivelling connection nipples press these balls against the seating of the connection holes (click here for design recommendation of connection holes). All pipes are test pressurized to 100 MPa (14,500 psi) above recommended maximum pressure. The recommended service life expiry date is marked on the pipe.



Technical data

Maximum pressure	300 MPa (43,500 psi)
Test pressure	400 MPa (58,000 psi)
Test quantity	100%
Outer diameter	± 4 mm (0.16 in)
Inner diameter	± 1,6 mm (0.06 in)
Other dimensions	See table below
Recommended service life	5 years after date of manufacture

Special pipes

On request pipes can be delivered in any length between 300 mm (12 in) and 4.000 mm (157 in). The required length must be added to standard designation; e.g. 227957 A / 3000 (length 3.000 mm; 118 in).

Pressure pipe 1020612 A is rated for 400 MPa (58,000 psi). Other pipes for higher pressures are available by special request.

Caution

The high pressure pipe may be dangerous if it is not used correctly or if damaged. Kindly note the following instructions:

- 1) Always check the pipe carefully before use (fitting of balls, deformations of pipe, etc.). Never use an even slightly damaged pipe
- 2) Bend the pipe to the desired working position before tightening the connection nipples. The balls may loosen if the pipe is bent when the connection nipples are locked
- 3) Before tightening the pipe on a pressure joint, be sure all air has been removed from injector and pipe
- 4) Never bend a pipe when pressurized

Technical data - dimensions

Designation	Dimensions												Weight	
	G ₁	G	A		A ₁		D _w		D _{w1}		L			
-	inch	inch	mm	inch	mm	inch	mm	inch	mm	inch	mm	inch	kg	lb
721740 A	G 3/4	G 1/8	11,5	0.45	36,9	1.45	7,94	0.31	15,88	0.63	1 000	39	0,3	0.7
227957 A	G 3/4	G 1/4	17,3	0.68	36,9	1.45	11,11	0.44	15,88	0.63	2 000	78	0,4	0.9
227958 A	G 3/4	G 3/4	36,9	1.45	36,9	1.45	15,88	0.63	15,88	0.63	2 000	78	0,6	1.3
1020612 A*	G 1/4	G 1/4	17,3	0.68	17,3	0.68	11,11	0.44	11,11	0.44	1 000	39	0,5	1.1
728017 A	G 1/4	G 1/4	17,3	0.68	17,3	0.68	11,11	0.44	7,94	0.31	300	12	0,2	0.4
727213 A**	G 1/4	G 1/4	17,3	0.68	17,3	0.68	7,94	0.31	7,94	0.31	300	12	0,2	0.4
729123 A	G 3/4	G 1/4	17,3	0.68	36,9	1.45	7,94	0.31	15,88	0.63	300	12	0,3	0.7

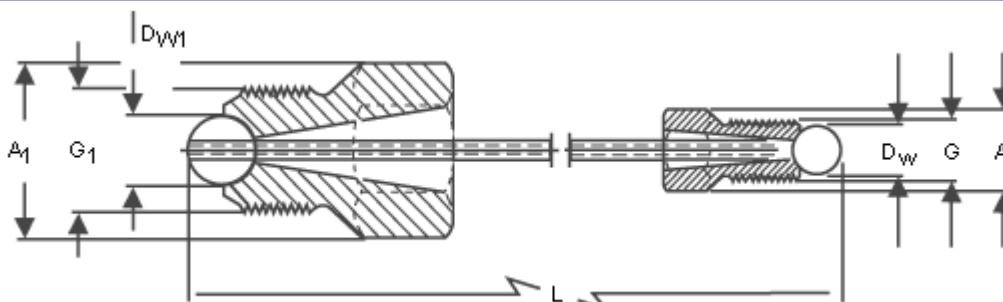

** The high pressure pipe /2/213 A is designed to fit small UK-couplings (UK 25-UK 75).

This pipe is not suitable for normal (40 bar) section (one hole).

ЗАО «БЕРГ АБ», (495) 727-22-72, promshop-biz@ya.ru, www.promshop.biz



© SKF Maintenance Products Date of issue: 2002-05-01