

Application

These plugs have been designed to seal off oil connections at a maximum pressure of 400 MPa (58,000 psi).

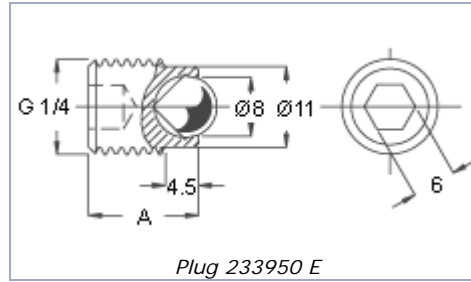

Plug 233950 E

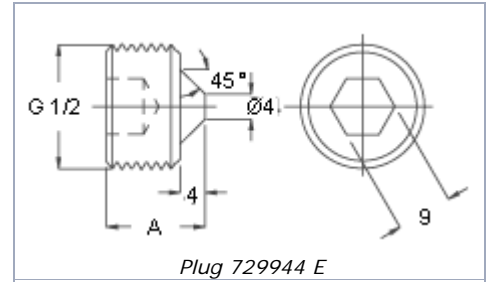

Plug 729944 E

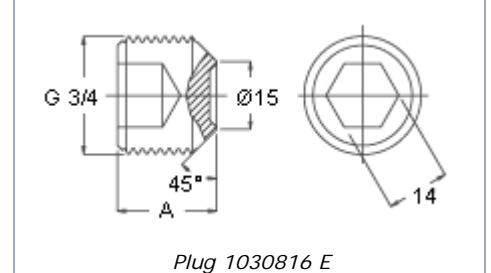

Plug 1030816 E

Technical data

Designation	Thread	Length A		Weight		Suitable hex. key	
		mm	inch	kg	lb	mm	inch
-	inch	mm	inch	kg	lb	mm	inch
233950 E	G 1/4	15	0.59	0,02	0.04	6	0.24
729944 E	G 1/2	17	0.67	0,03	0.07	9	0.35
1030816 E	G 3/4	23	0.90	0,05	0.11	14	0.55

